

MUSEUMSPACES

RA

Touring Hall

A contemporary architectural icon, Melbourne Museum is located opposite the Royal Exhibition Building, in the centre of the historic Carlton Gardens.

Grand Opportunity in a Grand Location

Exclusive availability to book from November 8 to December 24 in 2019 and January 27 to April 13 in 2020, Melbourne Museum's Touring Hall is a transformative space where anything is possible.

A spacious blank canvas that offers amazing opportunities to theme your event, the Touring Hall offers 885m² of versatile floor space, a private foyer and adjoining courtyard. Soaring high ceilings leave you free to install dramatic lighting, explore extensive production capabilities, or even create an avenue for aerial performers to entertain your guests.

Features

- A grand space of impressive scale
- There is no better (or bigger) space to realise your next imaginative event
- Anything is possible in this versatile space

Capacity

Banquet	600
Banquet with dancefloor	550
Theatre	1000
Cocktail	1000

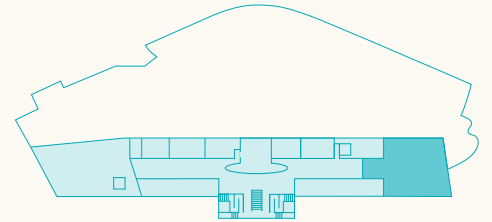



Melbourne Museum

11 Nicholson Street Carlton
Situating on the edge of the CBD

**Get in touch to book your next
event at the Touring Hall**

mmevents@restaurantassociates.com.au

museumspaces.com.au

03 8341 7400