



MUSEUMSPACES

RA

# The Long Room

A stately city oasis, Immigration Museum is located on Flinders Street in Melbourne's heritage-listed Old Customs House building, overlooking the Yarra River.

# Grand Opportunity in a Grand Location

**Available from October 18 to March 12, Immigration Museum's Long Room is an exciting opportunity for your next gala or cocktail party.**

The Palazzo-style Long Room, with its tall ceilings and iconic columns, once greeted jostling crowds of travellers arriving in Marvellous Melbourne. Inspiring in its size, the Long Room is ideal for a cocktail soir ee for up to 300 guests. Home to touring exhibitions, you can be assured that the Long Room will be adorned with a beautiful and insightful exhibition each time you entertain.

### Features

- Beautiful Victorian-era architecture, with tall Ionic columns, high ceiling, extensive hand-laid, detailed tiling
- A truly opulent atmosphere in a culturally significant landmark
- A grand theme in a perfect inner-city location

### Capacity

<b>Banquet</b>	200
<b>Banquet with dancefloor</b>	180
<b>Theatre</b>	300
<b>Cocktail</b>	300

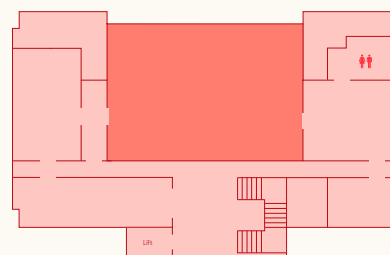

VAMFF photo credit Lucas Dawson







**Immigration Museum**

400 Flinders Street Melbourne  
Situated in the heart of the CBD

**Get in touch to book your next  
event at the Long Room**

[mmevents@restaurantassociates.com.au](mailto:mmevents@restaurantassociates.com.au)

[museumspace.com.au](http://museumspace.com.au)

03 8341 7400